

**Specifications**

Nominal Voltage		12 V
Capacity (25°C)	10HR(10.8V)	40 Ah
	5HR(10.5V)	35Ah
	1HR(9.60V)	25Ah
Dimension	Length	197±2mm (7.76inch)
	Width	165±2mm (6.50inch)
	Height	170±2mm (6.69inch)
	Total Height	170±2mm (6.69inch)
Approx. Weight		12kg (26.4lbs)±4%
Terminal type		T4/T9
Internal resistance (Fully charged, 25°C)		Approx. 8.5mΩ
Capacity affected by temperature (10HR)	40°C	102%
	25°C	100%
	0°C	85%
	-15°C	65%
Self-discharge (25°C)	3 month	Remaining Capacity: 91%
	6 month	Remaining Capacity: 82%
	12 month	Remaining Capacity: 65%
Nominal operating temperature		25°C ± 3°C (77°F ± 5°F)
Operating temperature range	Discharge	-15°C ~ 50°C (5°F ~ 122°F)
	Charge	-10°C ~ 50°C (14°F ~ 122°F)
	Storage	-20°C ~ 50°C (-4°F ~ 122°F)
Float charging voltage(25°C)		13.50 to 13.80V Temperature compensation: -18mV/°C
Cyclic charging voltage(25°C)		14.50 to 14.90V Temperature compensation: -30mV/°C
Maximum charging current		12A
Terminal material		Copper
Maximum discharge current		400A(5 sec.)
Designed floating life(20°C)		7~10 years

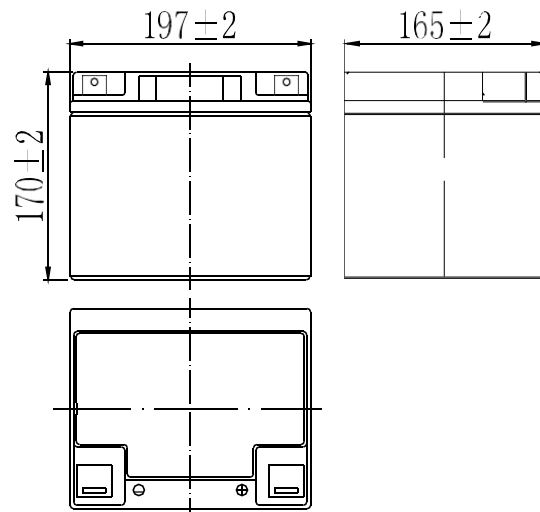

**Dimensions**



**Terminal**

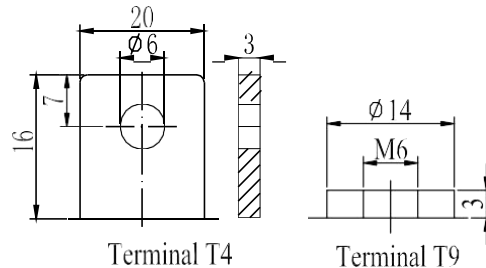

- ◆ Absorbent glass mat technology;
- ◆ Recognized by CE;
- ◆ ABS container.

**Constant Current Discharge Characteristics (A, 25°C)**

F.V/TIME	10min	15min	30min	60min	2h	3h	4h	5h	8h	10h	20h
9.60V	85.7	66.7	40.4	25.0	14.6	10.2	8.36	7.14	4.90	4.07	2.14
9.90V	83.1	65.1	39.6	24.7	14.5	10.1	8.31	7.10	4.87	4.06	2.13
10.2V	79.7	62.7	38.4	24.0	14.4	10.1	8.26	7.05	4.83	4.05	2.13
10.5V	76.3	60.5	37.5	23.6	14.2	10.0	8.20	7.00	4.80	4.03	2.11
10.8V	72.0	57.3	36.1	22.8	13.8	9.70	7.95	6.79	4.66	4.00	2.10

**Constant Power Discharge Characteristics (Watt, 25°C)**

F.V/TIME	10min	15min	30min	60min	2h	3h	4h	5h	8h	10h	20h
9.60V	925	732	453	286	169	120	98.4	84.4	58.2	48.6	25.7
9.90V	898	714	444	281	168	119	97.8	83.9	57.8	48.5	25.6
10.2V	861	688	431	274	167	118	97.1	83.3	57.4	48.4	25.5
10.5V	824	665	420	269	164	118	96.4	82.7	57.0	48.1	25.4
10.8V	777	629	405	260	160	114	93.5	80.3	55.3	47.8	25.2

Note: The above characteristics data can be obtained within three charge/discharge cycles.

**Discharge Characteristics(25°C)**

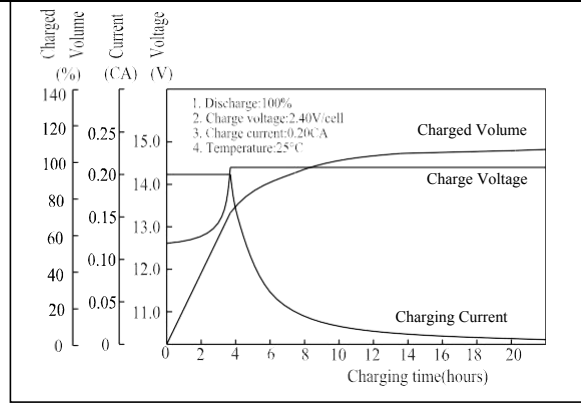
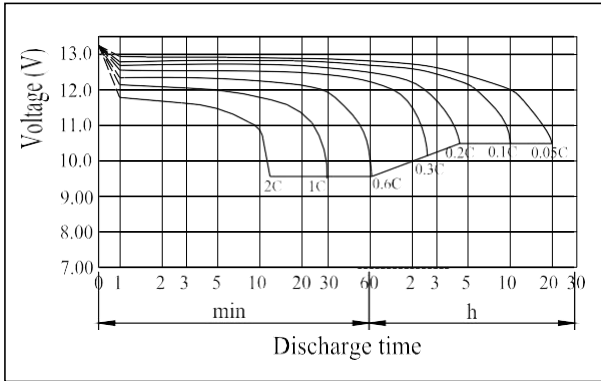

**Effect of Temperature on Capacity**

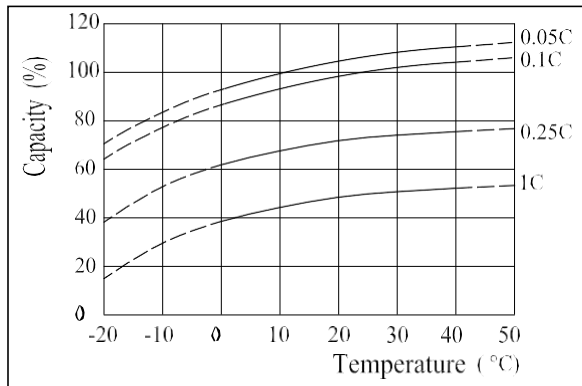

**Self-discharge Characteristics**

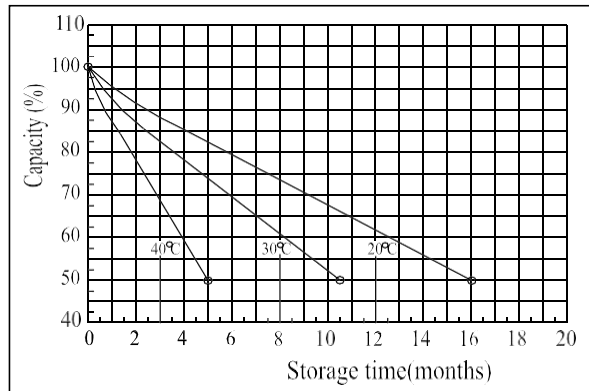

**The Relationship for Open Circuit Voltage and Residual Capacity (25°C)**

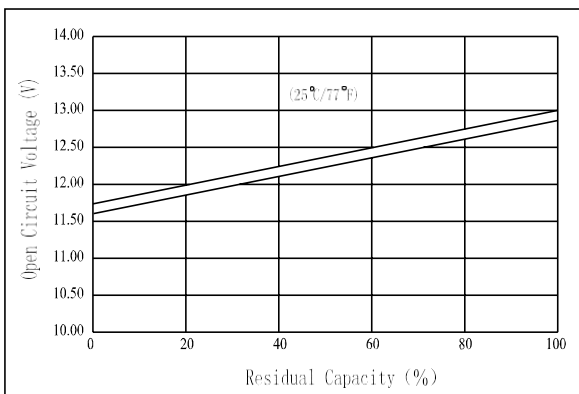

**The Relationship for Charging Voltage and Temperature**

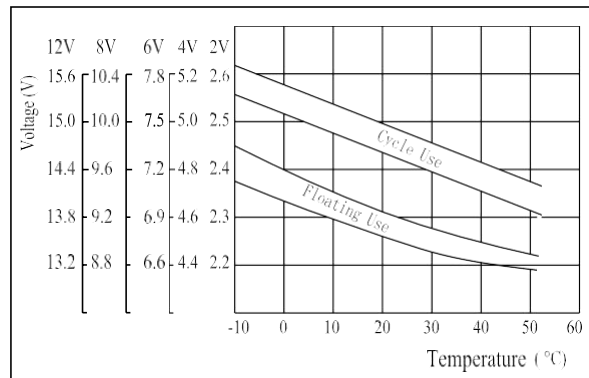

**Floating Life on Temperature**

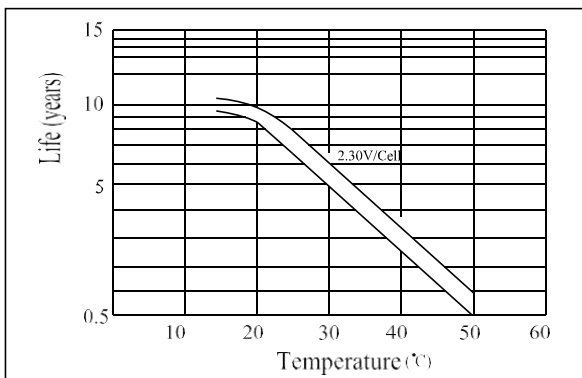

**Cycle Life on D.O.D(25°C)**

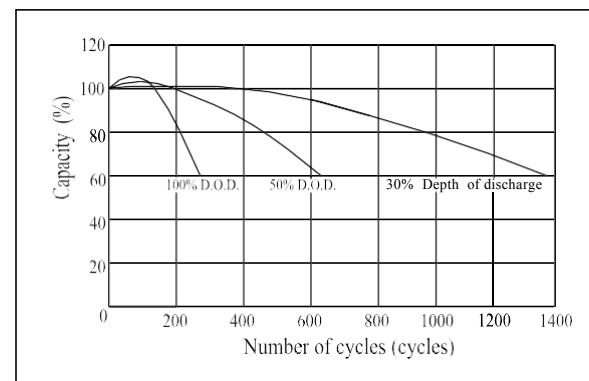

**Charging Characteristics(25°C)**