

## Real-time detection

After connect the zigbee door sensor to your zigbee hub, you will receive real-time detection of the opening / closing of the doors and windows.



# Smart door and window sensor

Real-time detection of the opening/closing  
of doors and windows



\*This product needs working with Tuya zigbee gateway

# Stick and use

Stick-on installation, can be installed on various doors, windows, drawers, etc., without destroying the original home structure and appearance.



# Real-time monitoring the opening /closing of doors and windows

After installing the sensor, you can remotely know if it is open or closed through APP. After leaving home, you are not sure whether the doors and windows are closed, you can check through App.

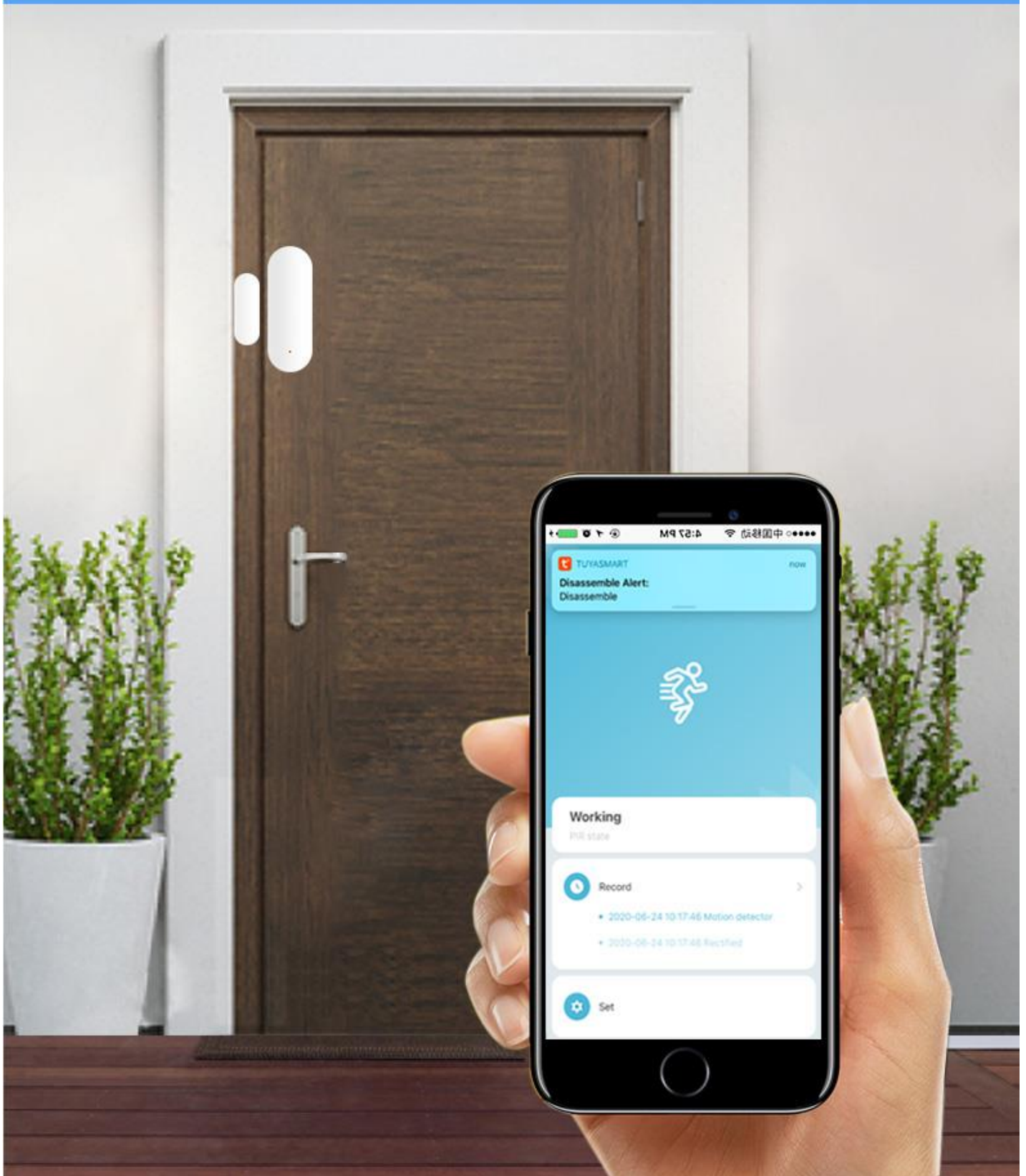



# Mobile photo notification

When the status of doors and windows changes, the mobile APP will receive real-time notification, to help us deal with any sudden situation.



# Various smart scene

With Zigbee smart gateway and other smart products, the door and window sensor can be set to different smart products for automation.

## Smart scene

When the doors and windows are closed, and nobody at home, the AWAY ARM smart scene will start automatically to detect any abnormal situations, such as intruders, gas leakage, water leakage, etc., and protect family and property safe.

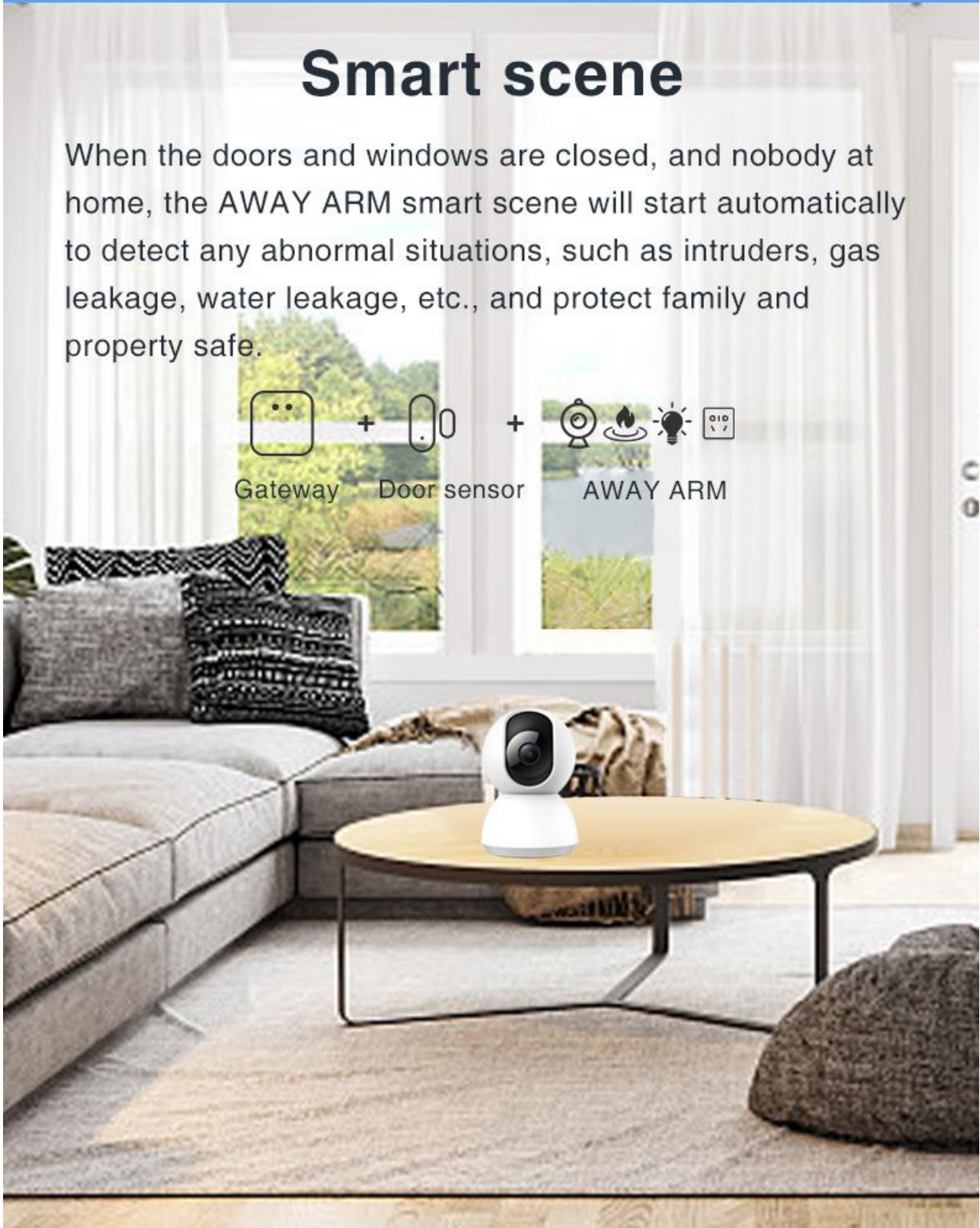

# Linkage switch automation

Turn on the air conditioner in advance on the way off work, and enjoy a cool room when you get home



Gateway + Door sensor + air conditioner





# Linkage equipments

Open the door in the evening, the living room lighting will turn on automatically, no need to find the switch in the dark



Voice Checking

# Support voice control, Alexa Google Assistant



Works with  
Amazon alexa



Works with  
Google Assistant



Works with  
**IFTTT**





# Step 1: Download the Tuya Smart APP



iOS/Android

Step 2: Open the Tuya APP to add a device

Step 3: Select Zigbee gateway device

Step 3: Press the indicator light to set

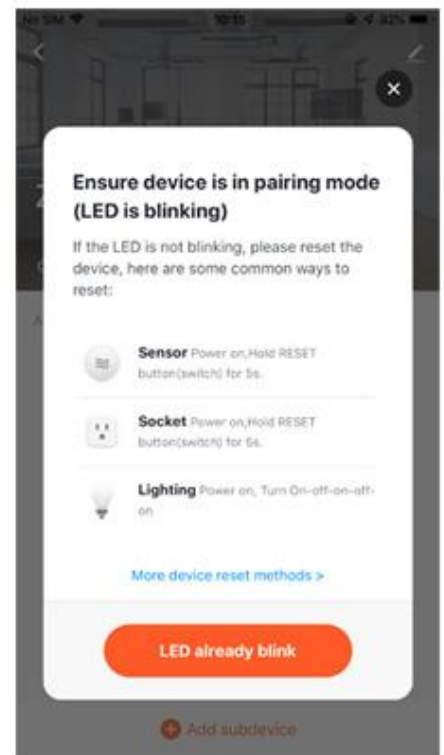
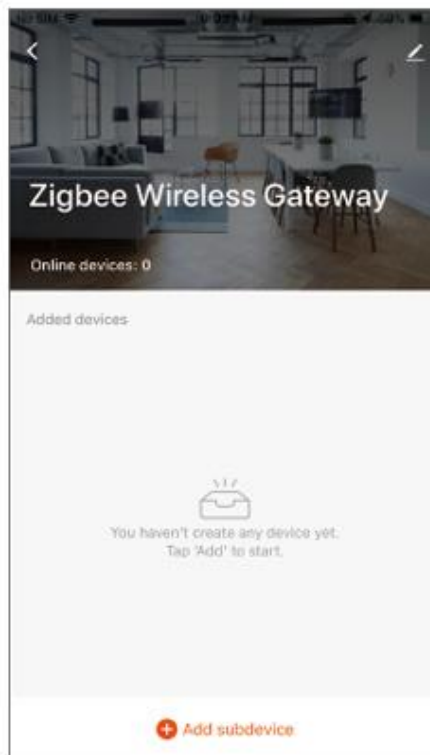
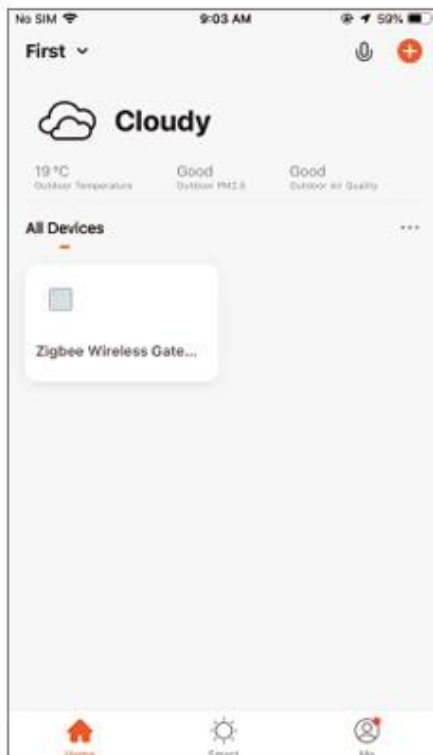

# Product Dimension

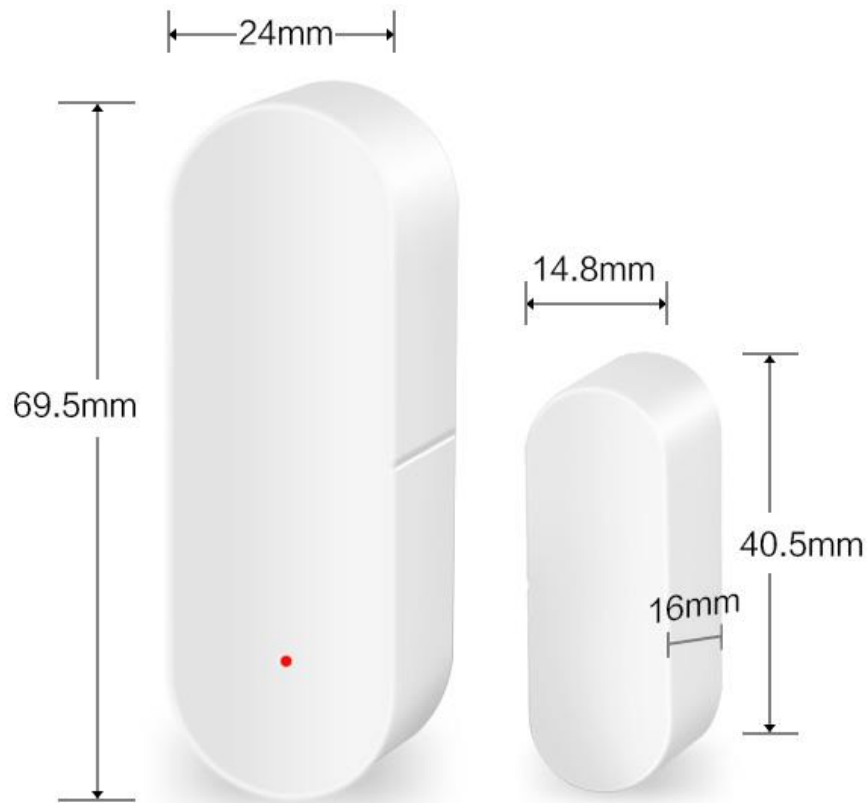

## Parameters:

Input voltage:	DC3V LR03*2
Standby current :	$\leq 10\mu\text{A}$
Alarming current :	$\leq 15\text{mA}$
Low-voltage notification :	$\leq 2.5\text{V}$
Zigbee frequency:	2.400GHz-2.484GHz
Magnetic control distant :	$\geq 15\text{mm}$
Working temperature :	-10-50°C
Working humidity :	$\leq 95\%RH$