

Specifications

Nominal Voltage		12 V
Capacity (25°C)	10HR(10.5V)	100 Ah
	5HR(10.2V)	78Ah
	1HR(9.6V)	58.2Ah
Dimension	Length	330±2mm (12.99inch)
	Width	171±2mm (6.73inch)
	Height	214±2mm (8.43inch)
	Total Height	220±2mm (8.66inch)
Approx. Weight		29.3kg(65lbs) ±3%
Terminal type		T11
Internal resistance (Fully charged, 25°C)		Approx. 5mΩ
Capacity affected by temperature (10HR)	40°C	103%
	25°C	100%
	0°C	88%
	-15°C	70%
Self-discharge (25°C)	3 month	Remaining Capacity: 94%
	6 month	Remaining Capacity: 88%
	12 month	Remaining Capacity: 75%
Nominal operating temperature		25°C±3°C(77°F±5°F)
Operating temperature range	Discharge	-15°C~55°C(5°F~131°F)
	Charge	-10°C~55°C(14°F~131°F)
	Storage	-20°C~55°C(-4°F~131°F)
Float charging voltage(25°C)		13.50 to 13.80V Temperature compensation: -18mV/°C
Cyclic charging voltage(25°C)		14.10 to 14.40V Temperature compensation: -30mV/°C
Maximum charging current		20A
Terminal material		Copper
Maximum discharge current		800A(5 sec.)
Designed floating life(20°C)		12 years

- Gelled electrolyte technology;
- PVC separator;
- Recognized by CE;
- ABS container.



Dimensions

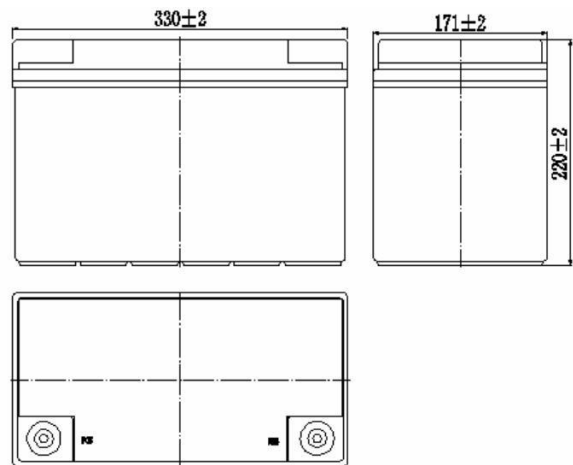

Terminal

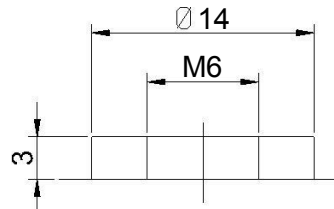

Terminal T11

Constant Current Discharge Characteristics (A, 25°C)

F.V/TIME	10min	15min	30min	60min	2h	3h	4h	5h	8h	10h	20h
9.60V	214	167	101	62.6	36.5	25.5	20.9	17.9	12.2	10.2	5.34
9.90V	208	163	99.0	61.7	36.3	25.4	20.8	17.7	12.2	10.2	5.33
10.2V	199	157	96.0	60.1	36.0	25.2	20.6	17.6	12.1	10.1	5.32
10.5V	191	151	93.6	58.9	35.5	25.0	20.5	17.5	12.0	10.1	5.29
10.8V	180	143	90.2	57.1	34.6	24.3	19.9	17.0	11.6	10.0	5.25

Constant Power Discharge Characteristics (Watt, 25°C)

F.V/TIME	10min	15min	30min	60min	2h	3h	4h	5h	8h	10h	20h
9.60V	2313	1830	1133	714	423	300	246	211	145	122	64.1
9.90V	2244	1786	1111	703	421	298	244	210	145	121	64.0
10.2V	2151	1720	1077	685	417	296	243	208	144	121	63.8
10.5V	2059	1661	1050	672	411	294	241	207	143	120	63.4
10.8V	1943	1574	1012	651	400	285	234	201	138	119	63.0

Note: The above characteristics data can be obtained within three charge/discharge cycles.

Discharge Characteristics(25°C)

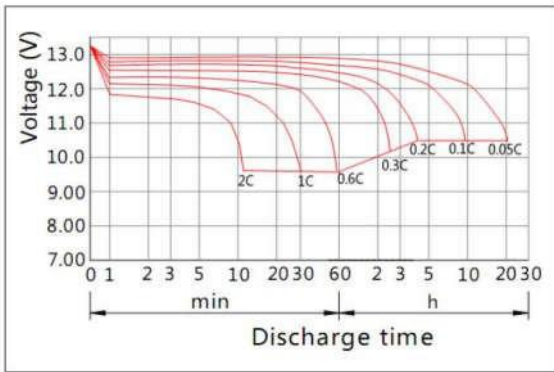

Charging Characteristics(25°C)

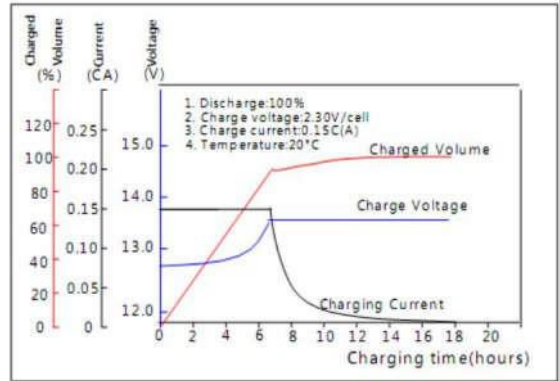

Effect of Temperature on Capacity

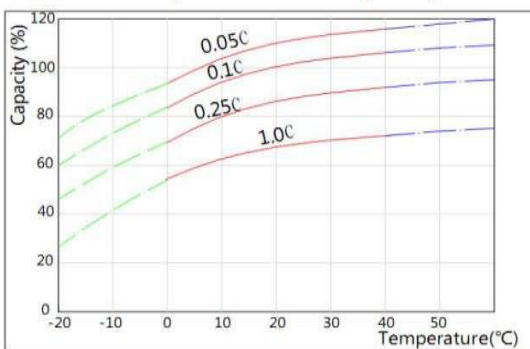

Self-discharge Characteristics

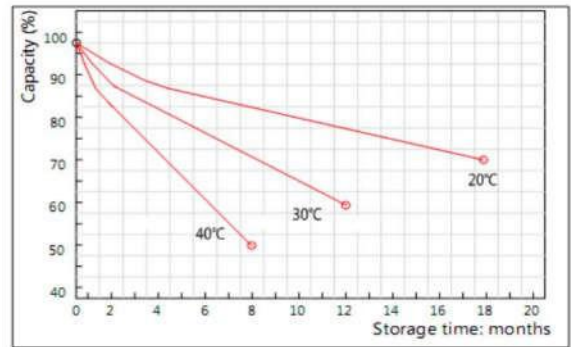

The Relationship for Open Circuit Voltage and Residual Capacity (25°C)

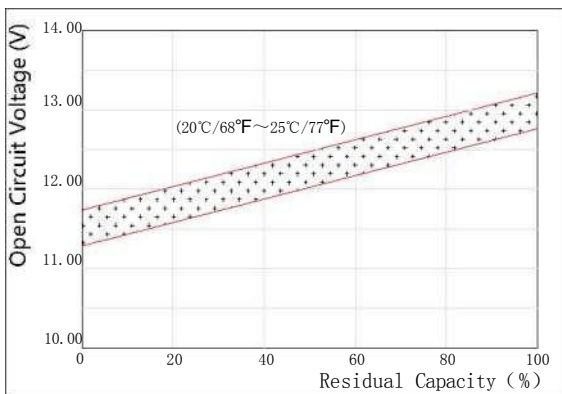

The Relationship for Charging Voltage and Temperature

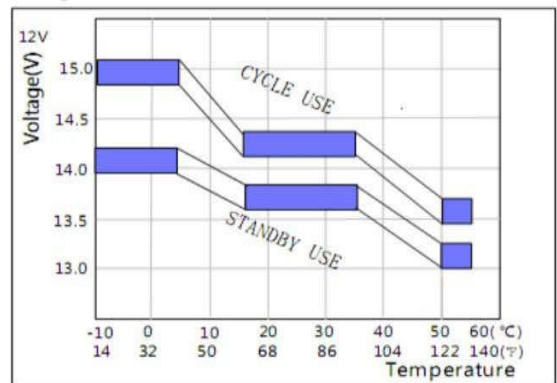

Floating Life on Temperature

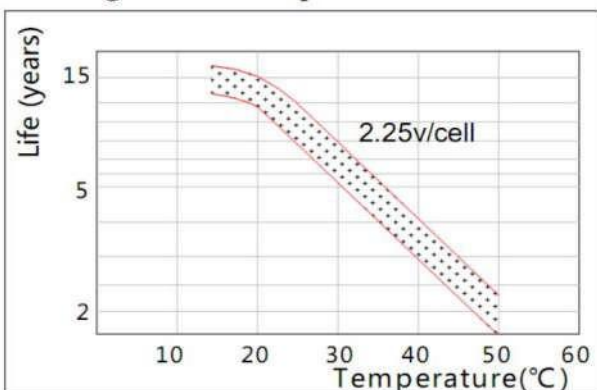

Cycle Life on D.O.D(25°C)

