

NO.9892C1

2LED ELASTIC BELT TYPE MAGNIFIER

Lens Gauge: 85mmx28.5mm

Lens Magnification: 1X, 1.5x, 2x, 2.5x, 3.5x

Dual Lens Magnification: 3.0x, 4.0x, 4.5x, 5.0x, 5.5x, 6.0x

Battery model: AAA Voltage: 1.5V Quantity: 3

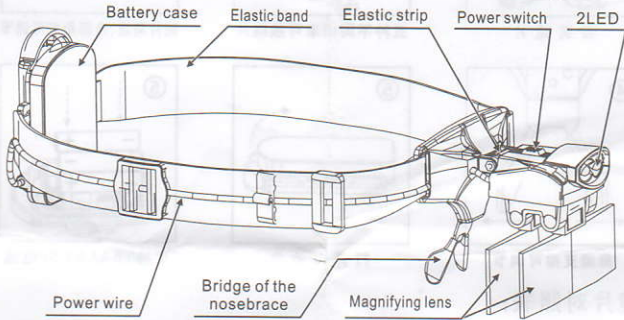

Scope of use:

For reading, handicrafts, mechanical manufacturing, electronic maintenance, gardening and home life.

Product features:

1. The lamp holder is an independent and innovative spring locking up and down adjusting device, which enables the LED light source to more effectively irradiate the observed object range.
2. The rear connected independent battery compartment design makes the lamp head lighter. It can also carry three AAA1.5V batteries with large capacity, making the LED brighter and longer in use.
3. Add the bridge support under the LED lamp holder bracket, which can effectively relieve the pressure on the forehead, prevent the lamp holder bracket from sliding off the forehead, and make the use more comfortable.

Operating guide:

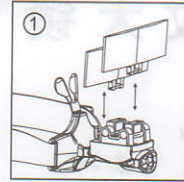

Installation of lens

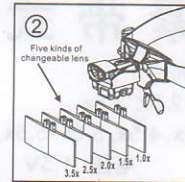

Five kinds of changeable lens of different magnifications

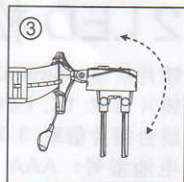

Lens angle, light source angle is adjustable.

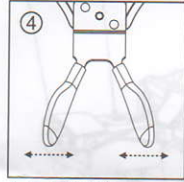

Adjustable bridge support

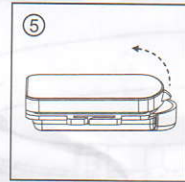

Open the battery box

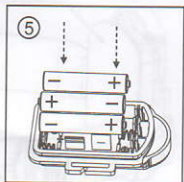

Replacement 3 AAA1.5V of batteries

Lens comparison table:

Magnification	Focus
1.0x	500mm
1.5x	333mm
2.0x	250mm
2.5x	200mm
3.5x	142mm

Combination magnification	Focus
1.0x+2.0x	166mm
1.5x+2.5x	125mm
2.0x+2.5x	111mm
1.5x+3.5x	100mm
2.0x+3.5x	90mm
2.5x+3.5x	83mm

Safety precautions:

1. Do not place the magnifying glass in the direct sunlight to avoid fire.
2. Do not use a magnifying glass to observe the sun so as not to burn your eyes.
3. Please use soft cloth or cleaning paper to clean the lens.
4. The lens can also be wiped with a small amount of detergent wet cloth, and then wiped with a clean water wet cloth.
5. Do not use alcohol, gasoline and other chemical liquids to wipe the lens and shell.