

圖號 DRAWING No. :

品名 NAME:Female

ITEM No. :

校訂版次 REVISIONS

版次	記述 DESCRIPTION	DATE	核可
1	更改產品尺寸	106.05.11	ANDY
2	修改公差	106.09.27	ANDY

NOTE:

1. MAXIMUM ELECTRICAL RATING: 105°C 300 VOLTS
2. WIRE RANGE: 22-16 AWG / 0.5-1.5 mm²
INSULATED COLOR: RED
3. WIRE RANGE: 16-14 AWG / 1.5-2.5 mm²
INSULATED COLOR: BLUE
4. WIRE RANGE: 12-10 AWG / 4-6 mm²
INSULATED COLOR: YELLOW
5. MATERIAL THICKNESS: t
TOLERANCE: ±0.05



MAXIMUM ELECTRIC CURRENT

A. W. G	22	20	18	16	14	12	10
MAX AMP	3	4	7	10	15	20	24

WIRE RANGE AWG/mm ²	產品編號 ITEM NO.	NEMA TAB	B	F ±0.30	L ±1.00	E ±0.60	D ±0.30	d1 ±0.20	t
22-16 AWG 0.5-1.5 mm ²	B	0.5x2.8	3.2±0.30	6.4	19.0				0.25
	B	0.8x2.8	3.2±0.30	6.4	19.0				0.25
	A	0.5x4.8	5.0±0.20	6.5	20.0	10.0	4.0	1.7	0.35
	A	0.8x4.8	5.0±0.20	6.5	20.0				0.35
	A	ST-010/R	0.8x6.4	6.6±0.20	7.9	22.0			0.4
16-14 AWG 1.5-2.5 mm ²	B	0.5x2.8	3.2±0.30	6.4	20.0				0.25
	B	0.8x2.8	3.2±0.30	6.4	20.0				0.25
	A	0.5x4.8	5.0±0.20	6.5	21.0	10.0	4.5	2.3	0.35
	A	0.8x4.8	5.0±0.20	6.5	21.0				0.35
	A	0.8x6.4	6.6±0.20	7.9	22.0				0.4
12-10 AWG 4-6 mm ²	A	0.8x6.4	6.6±0.20	7.9	25.0	13.0	5.5	3.4	0.4
	A	1.2x9.5	9.9±0.20	12.5	29.0				0.5

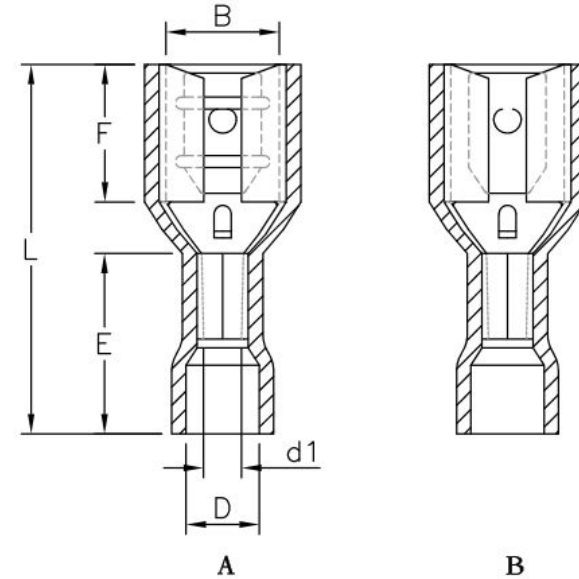

認可 APPROVALS

製圖 DRAFT: TINA
設計 DESIGN: KEN
核可 CHECKED: ANDY

第三視角
THIRD VIEW

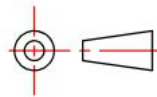

MATERIAL

INSULATION: VINYL
MATERIAL: BRASS
TIN PLATING

單位 UNIT

m/m
比例 SCALE

日期 DATE: 2015.01.05