

Feature

- Good shock performance by large current
- Good fire-resistance performance and isolation
- Small size, light weight and safe application

Application

- Small solar heater
- Heater with power no more than 900W/220V, if no heat-sink device is applicate

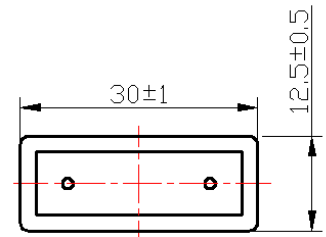
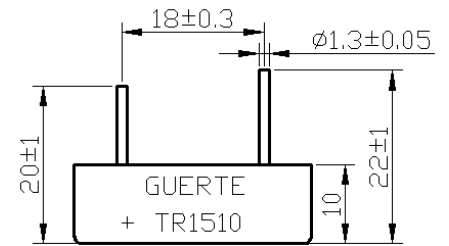

■ Maximum value

Symbol	Parameter	Rating	Unit
		TR1510	
V_{RRM}	Peak reverse repetitive voltage	1000	V
V_{RSM}	Peak reverse non-repetitive voltage	1100	V

Symbol	Parameter	Test condition	Rating	Unit
$I_{F(AV)}$	Forward average current	180° sine half-wave 50Hz single-sided heat dissipation $T_C=78^\circ\text{C}$	15	A
I_{FSM}	Forward surge current	$t=10\text{ms}, 50\text{Hz}, \text{sin}, T_{jm}$	180	A
I^2t	I^2t value		240	A^2S
V_{ISO}	Isolation voltage	50Hz, R.M.S, $t=1\text{min}$, $I_{iso}:1\text{mA}(\text{max})$	2500	V
T_j	Operating junction temperature		-40 to +150	$^\circ\text{C}$
T_{jm}	Rated junction temperature		150	$^\circ\text{C}$
T_{stg}	Storage temperature		-40 to +120	$^\circ\text{C}$
W_t	Weight		16	g

■ Electrical characteristics

Symbol	Parameter	Test condition	Rating	Unit
I_{RRM}	Peak reverse repetitive current	$V_R=V_{RRM}$, sine half-wave, $T_j=25^\circ\text{C}$	5	μA
		$V_R=V_{RRM}$, sine half-wave, $T_j=150^\circ\text{C}$	3	mA
V_{FM}	Peak forward voltage	$I_{FM}=45\text{A}$, $T_j=25^\circ\text{C}$	1.3	V