

Model No.: **GP35AAH**

Type	: Rechargeable Nickel Metal Hydride Cylindrical Cell
Nominal Dimension (with Sleeve)	: $\Phi = 10.4\text{mm}$ H = 22.7mm
Applications	: Recommended discharge current 35 to 1050mA
Nominal Voltage	: 1.2V
Capacity	: Nominal: 350mAh Minimum: 350mAh Typical: 360mAh When discharged at 70mA to 1.0V at 20°C
Charging Condition	: 35mA for 16 hrs at 20°C
Fast Charge	: 175mA to 350mA (0.5 to 1C) charge termination control recommended control parameters: - ΔV : 0-5mV **DT/dt : 0.8°C/min (0.5 to 0.9C) 0.8 - 1°C/min (1C) **TCO : 45 - 50°C **Timer : 105% nominal input ** for ref. only
Service Life	: >500 cycles (IEC standard)
Continuous Overcharge	: 35mA maximum current for 1 year. No conspicuous deformation and/or leakage
Weight	: 6.25g
Internal Resistance	: Average 60m Ω upon fully charged (Range 40 - 80m Ω) at 1000Hz
Max. Charging Voltage	: 1.5V at 35mA charging
Ambient Temperature Range	: Standard Charge : 0 to 45°C Fast Charging : 10 to 45°C Discharge : -20 to 50°C Storage : -20 to 35°C

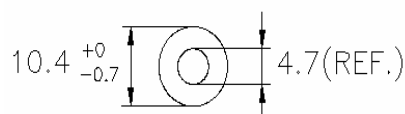
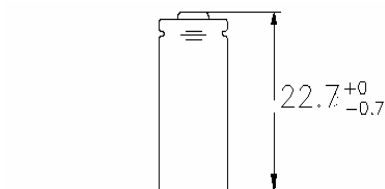

Unit:mm

Low Rate Discharge

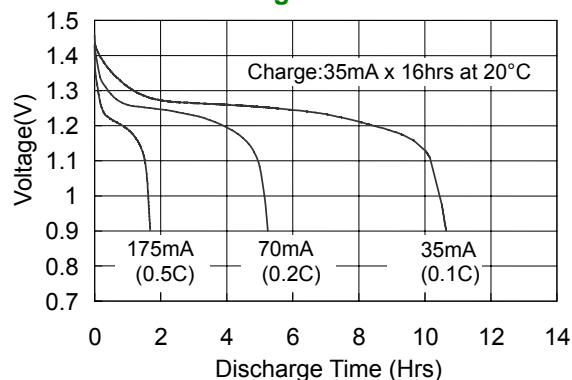

High Rate Discharge

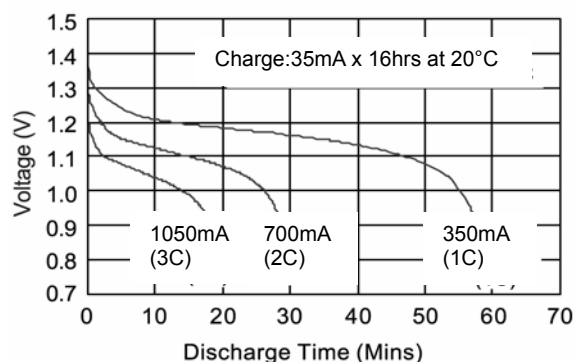

Fast Charge (Charge control required)

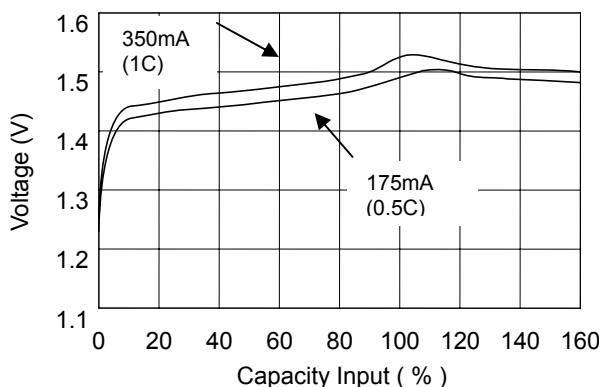

The information (subject to change without prior notice) contained in this document is for reference only and should not be used as a basis for product guarantee or warranty. For applications other than those described here, please consult your nearest GP Sales and Marketing Office or Distributors.