

- Material acc. to DIN 176: 11 SMn Pb30
- Minimum tensile strength: 500 N/mm<sup>2</sup>
- Surface finish acc. to DIN 267: galvanised (A3 F)
- Material number: 1.0718
- Tolerance for length dimensions +/- 0.1 mm (DIN 2768-m applies to SW13)
- All articles are also available without undercut.

- Available from stock. Delivery times for intermediate lengths and special versions upon request.



## Standard range – spacer bolts [ Zinc, plated ]

### EXECUTION DIA [ Internal / external thread ]

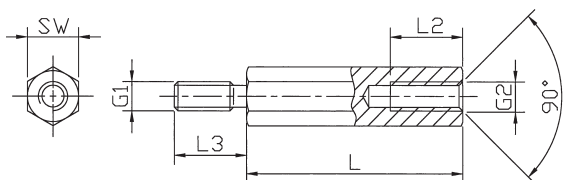

### Internal thread lengths [ mm ]

L	L2 at M2.5-M5	L2 at M2	L2 at M6	L2 at M8
5	3	3		
8	5	5		
10	6	6	6	
12	7	6	7	
15	10	6	10	10
18	10	6	10	
from 20	10	6	12	14

### External thread lengths [ mm ]

G1=G2	L3
M2	5
M2,5	6
M3	6
M4	8
M5	8
M6	10
M8	14

Order No.	Execution	Material	SW* (hexagon)	Thread	Standard lengths in mm
221 x (length)	DIA	Steel	SW4	M2	5, 8, 10, 12, 15, 18, 20, 25, 30, 35, 40
2212 x	DIA	Steel	SW4	M2.5	5, 8, 10, 12, 15, 18, 20, 25, 30, 35, 40
223 x	DIA	Steel	SW5	M3	5, 8, 10, 12, 15, 18, 20, 25, 30, 35, 40, 45, 50
224 x	DIA	Steel	SW5.5	M3	5, 8, 10, 12, 15, 18, 20, 25, 30, 35, 40, 45, 50, 55, 60, 65, 70
225 x	DIA	Steel	SW6	M3	5, 8, 10, 12, 15, 18, 20, 25, 30, 35, 40, 45, 50, 55, 60, 65, 70, 75, 80, 85, 90, 95, 100
226 x	DIA	Steel	SW7	M4	5, 8, 10, 12, 15, 18, 20, 25, 30, 35, 40, 45, 50, 55, 60, 65, 70, 75, 80, 85, 90, 95, 100
227 x	DIA	Steel	SW8	M4	5, 8, 10, 12, 15, 18, 20, 25, 30, 35, 40, 45, 50, 55, 60, 65, 70, 75, 80, 85, 90, 95, 100
228 x	DIA	Steel	SW8	M5	8, 10, 12, 15, 18, 20, 25, 30, 35, 40, 45, 50, 55, 60, 65, 70, 75, 80, 85, 90, 95, 100
229 x	DIA	Steel	SW10	M6	10, 12, 15, 18, 20, 25, 30, 35, 40, 45, 50, 55, 60, 65, 70, 75, 80, 85, 90, 95, 100
2213 x	DIA	Steel	SW13	M8	15, 20, 25, 30, 35, 40, 45, 50, 55, 60, 65, 70, 75, 80, 85, 90, 95, 100

\*SW: width across flats

Ordering example: 229 x 50 = DIA / St / SW10 / M6 x 50